

### Product Specifications

Width	1.25 inch
Height	4.25 inch
Depth	1 inch
Weight	.025 lbs
Max spacing	48" on center
Recommended load	36 lbs ~ 3 drywall layers
Max safe load	46 lbs ~ 4 drywall layers
Fail load	300 lbs ~ 27 drywall layers

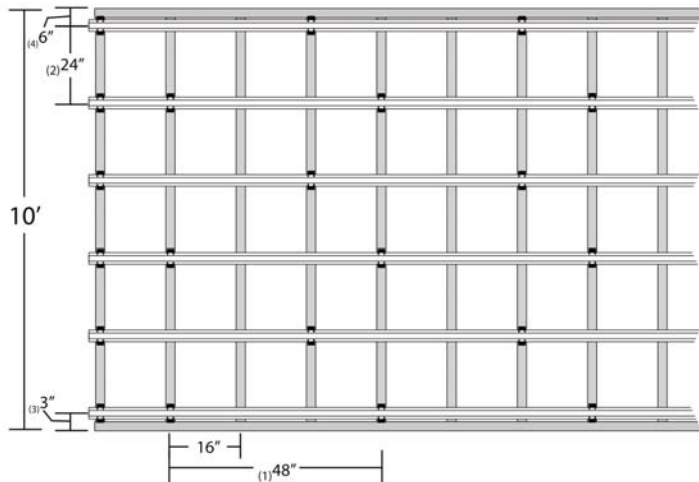

Layout pattern for Green Glue Noiseproofing Clips

### Green Glue Noiseproofing Clip Layout

- (1) Clips are spaced no further than 48 inches apart horizontally
- (2) Hat channel must not be spaced more than 24 inches vertically
- (3) Bottom clips must be less than 3 inches from the floor
- (4) Top clips must be less than 6 inches from the ceiling\*

Clips must be placed at the outermost studs on every piece of hat channel

\* For ceiling installation, the same pattern is used. However the 3" minimum spacing should be used at the drywall edges to ensure proper support for the sheet, not 6" as used for walls.



### Step 1

Measure for placement of Green Glue Noiseproofing Clips using layout guidelines listed above. Mark locations and install clips using appropriate screws.

#### Recommended screws by stud type

Wood :	Use #8 x 1-5/8" or longer Coarse thread screws
Steel :	Use #8 x 1-1/4" or longer Type S self tapping screws
Concrete :	Use 3/16" dia x 2-1/4" Tapcon or equal anchor screw

Outermost clips must be spaced at every interval

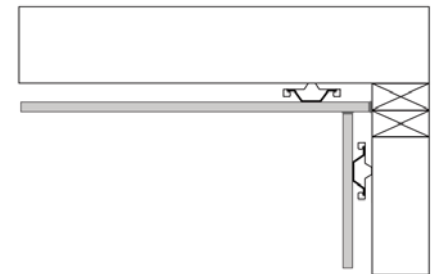

Installing ceiling drywall before walls to allow for a fire stop by butting ceiling drywall to studs

### Step 2

Snap appropriate hat channel into clips

#### Recommended hat channel

Size : 25 gauge hemmed edges  
Depth : 7/8"  
Width top : 1 1/4"  
Width bottom : 2 1/2"

Most walls will require you to overlap hat channel, instructions for doing so are as follows.

Overlap 6 inches of hat channel between two clips.

Secure the hat channel with two 7/16" framing screws.

18 gauge tie-wire can also be used.



### Step 3

Place shims on the floor to allow spacing between the drywall and the flooring. This ensures decoupling from the floor to make it impossible for vibrations to travel from wall to floor and vice-versa.

Screw drywall in place through hat channel. Be sure drywall is fully installed before removing shims from underneath.

### Step 4

Be sure to use an acoustical sealant to fill gaps around electrical boxes, windows, doors, and areas below or above sheets of drywall. Green Glue Noiseproofing Sealant is perfect for this application as it allows flexibility while stopping sound from transmitting through unsealed areas.



Scan & watch our clip installation video