

# GREEN GLUE VS. ENGINEERED DAMPING GLUE

One frequent and rational asked question about Green Glue is: "Does Green Glue outperform Engineered Damping Glue."

## TEST DESCRIPTION - CONSTRUCTION ADHESIVE -VS- GREEN GLUE ASSEMBLY

To address this question, The Green Glue Company ran a series of tests at Orfield Laboratories, a NVLAP certified independent lab in Minneapolis, MN. Below are the wall configurations, from source room to receive room. All details of the walls were identical, including insulation, screw length and spacing, stud configurations, and so forth.

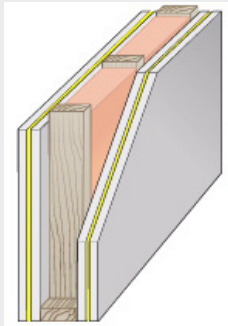

Engineered Damping Glue Adhesive
5/8" drywall + Engineered Damping Glue @ 2.5 tubes per 4'x8' sheet + 5/8" drywall
2x4 Wood Stud (24" OC)
R13 fiberglass insulation
5/8" drywall + Engineered Damping Glue @ 2.5 tubes per 4'x8' sheet + 5/8" drywall
OL 06 940

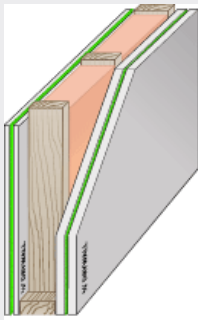

Green Glue Assembly II
5/8" Drywall Green Glue (2 tubes per 4'x8' sheet)+ 5/8" Drywall
2x4 Wood Stud (24" OC)
R13 fiberglass insulation
5/8" drywall + Green Glue @ 2 tubes per 4'x8' sheet + 5/8" drywall
OL 05 1049

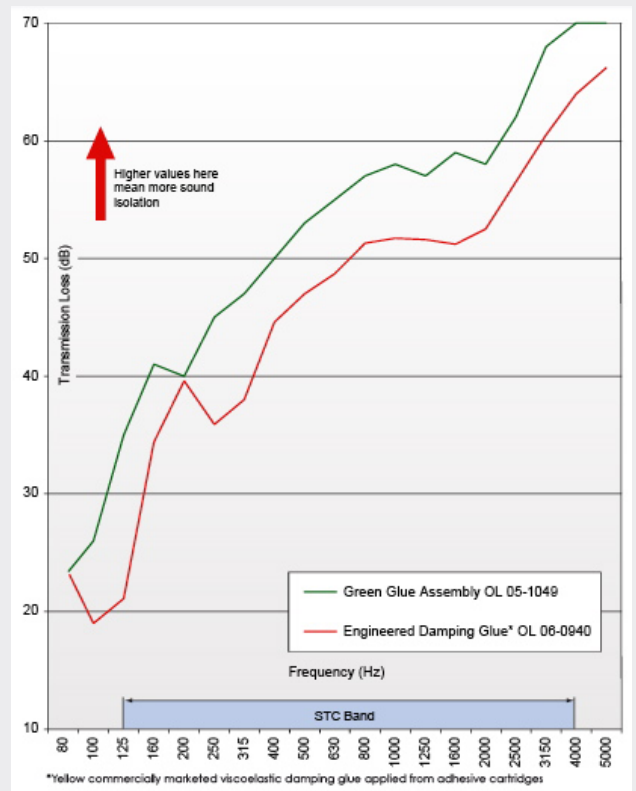

### SUMMARY

Engineered Damping Glue was purchased by independent contractors through standard retail channels.

Independent contractor assembly was conducted under lab supervision at Orfield Laboratories. Glue was applied according to the manufacturer's instructions.

The process was filmed and a wall sample retained by the lab. See certified test report for more details.

Wall Setup	STC	OTC
Engineered Damping Glue	45	33
Green Glue	55	39